

Lewmar

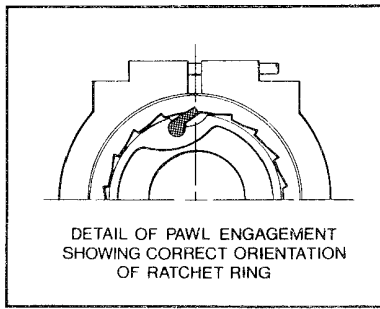

DETAIL OF PAWL ENGAGEMENT
SHOWING CORRECT ORIENTATION
OF RATCHET RING

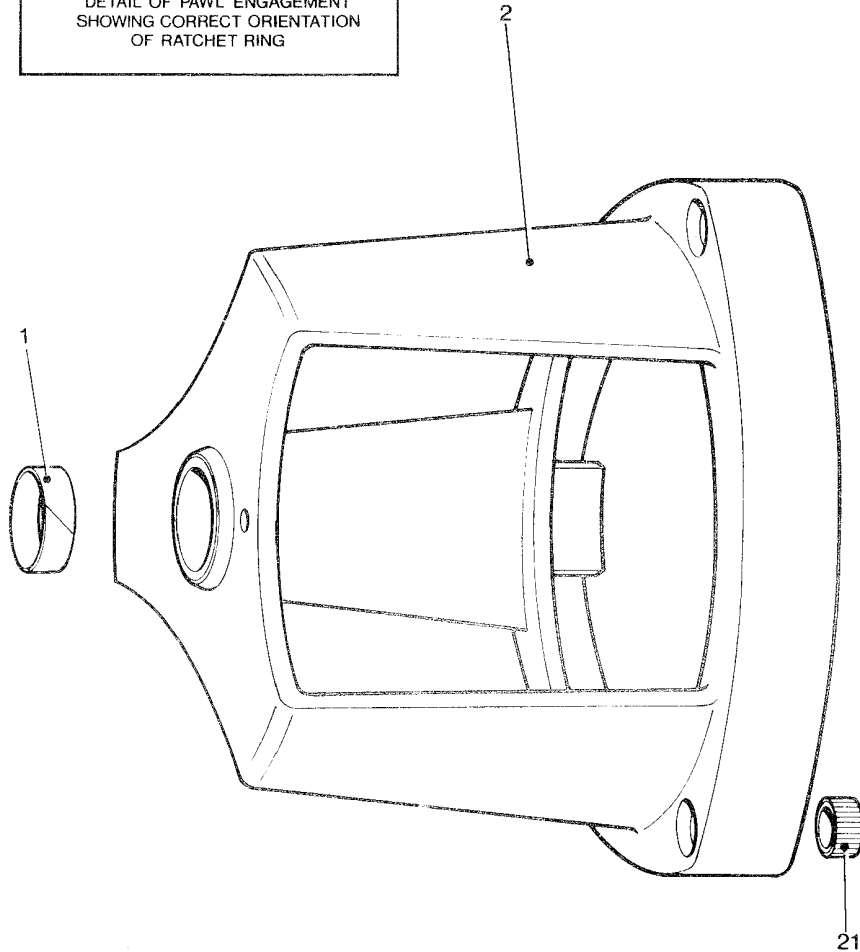

Halliard Reel winches

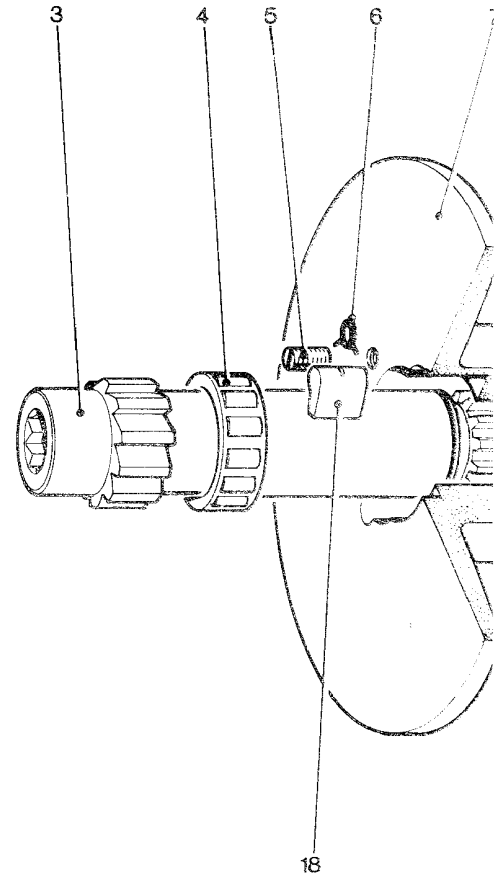

Maintenance No.3

A Remove halliard wire from drum (7) by releasing grub screws (5) and remove winch from boat.

B Remove base plate (14) by releasing six allen screws (13).

C Remove locking arm (11).

D Lift off brake strap (15).

E Remove ratchet ring (16).

F Before removing planet wheel assembly (17), mark clearly each idler gear (10) and opposing gear teeth on drum (7) so that it can be reassembled in the same mesh.

G Remove planet wheel assembly (17) from spindle (3).

H Remove spindle (3), complete with bearings (4 & 20) and spacer (8) from drum (7).

I Remove bearings (4 & 20) and spacer (8) from spindle (3) by removing circlip (19).

J Remove drum (7) from drum casing (2).

K Clean outer surface of ratchet

ring (16) with light abrasive.

L Clean thoroughly all parts using kerosene (paraffin) or white spirit. Dry with a non-fluffy cloth. Ensure that the outer surface of ratchet ring (16) and inner surface of brake strap (15) are free from grease.

M Check tape bearing (1) in drum casing (2).

N Check that pawls and springs (18 & 6) in drum (7) are free and oil lightly.

O Replace bearings (4 & 20) and spacer (8) on spindle (3) retaining them with circlip (19) and lightly grease.

P Insert spindle assembly (3) in drum (7).

Q Place drum (7) and spindle (3) in drum casing (2).

R Check that pawls and springs (18 & 6) on planet wheel assembly (17) are free and oil lightly.

S Lightly grease idler gears (10).

T Replace planet wheel assembly (17) on spindle (3) ensuring that

gears are meshed as marked in F above.

U Replace ratchet ring (16) on planet wheel assembly (17). Check that ratchet ring (16) is fitted correctly to ensure that pawls (18) are properly located in ratchet ring (16). See inset detailed drawing.

V Fit brake strap (15) over ratchet ring (16).

W Replace locking arm (11) in brake strap (15).

X Replace base plate (14) and fasten with six allen screws (13).

Y Replace winch on boat.

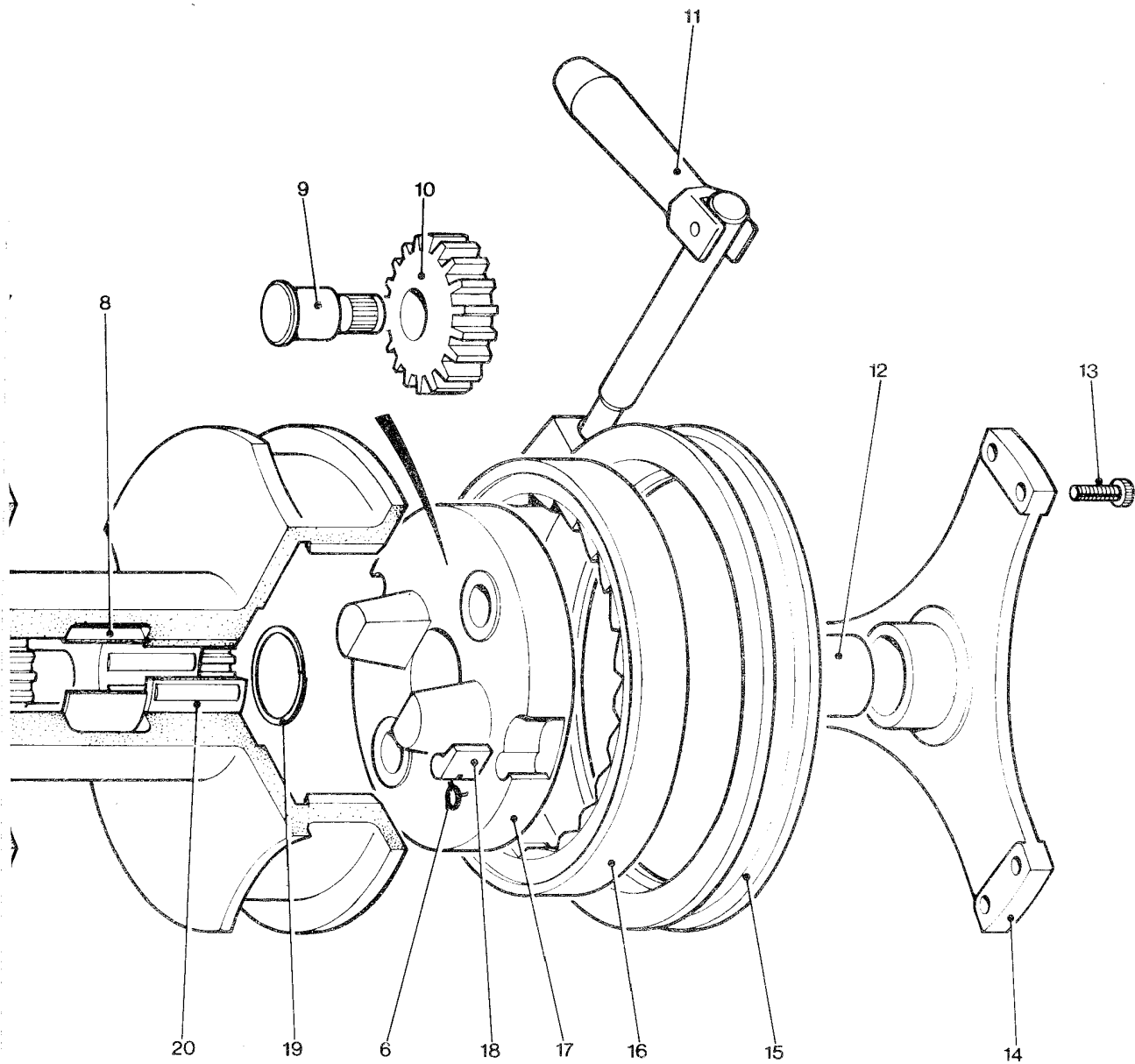

Parts list

Item Number	Part Number	Description	No. Off
1	1283/12	Tape Bearing	1
2	1283/1	Drum Casing	1
3	1283/7	Main Spindle	1
4	1287/SA1	Cage Assembly Bearing	1
5	B0901	1/4" x 20 UNC Grub Screw x 3/8" long	2
6	1260/7	Pawl Spring	4
7	1283/2	Drum	1
8	1283/15	Tube Spacer	1
9	1283/9	Idler Gear Spindle	2
10	1283/8	Idler Gear	2
11	15001009	Handle Rivet	* 1
	1283/20	End Piece	
	1283/19	Brake Lever	
	1283/10	Brake Screw	
12	B1630	Bush	1

13	B0705	2BA Cap Hd Socket Screw 1/2" long	6
14	1283/5	Base Plate	1
15	1283/4	Brake Strap	1
16	1283/3	Ratchet Ring	1
17	1283/6	Planet Carriage	1
18	1264/8	Pawl	4
19	B2075	Spirolox Circlip	1
20	1264/SA2	Cage Assembly Bearing	1
21	1283/13	Casing Insert	3

* Fixed Assembly

Spare Parts Kit
Halliard Reel No 3
Cat No 19703400

Contents
4 x Spring Pt No 1260/7
4 x Pawl Pt No 1264/8
2 x Grub Screw Pt No B0904
2 x Grub Screw Pt No B0901